

CODICE DI ORDINAZIONE
ORDERING CODE

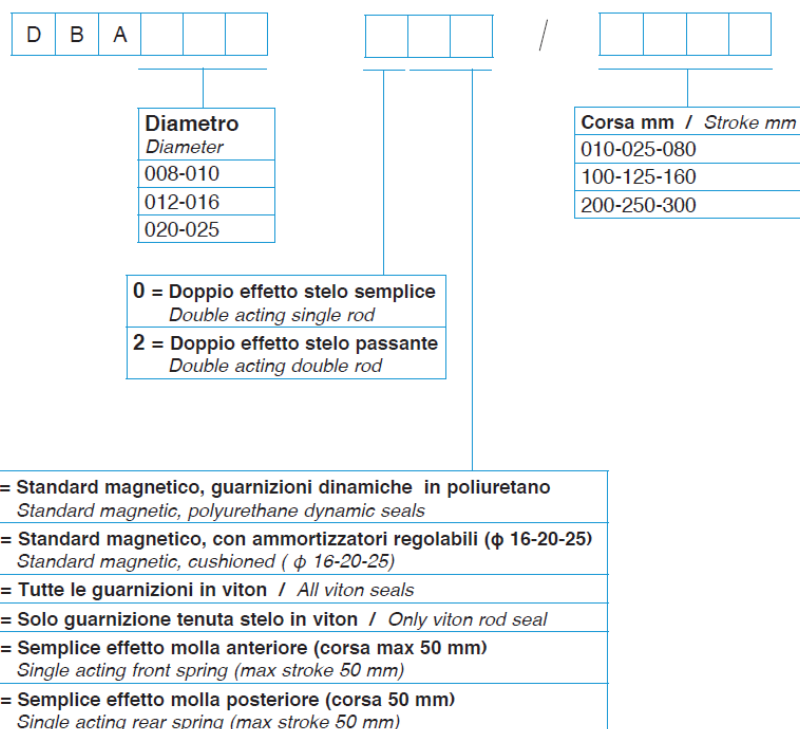

DOPPIO EFFETTO STELO PASSANTE
DOUBLE ACTING DOUBLE ROD

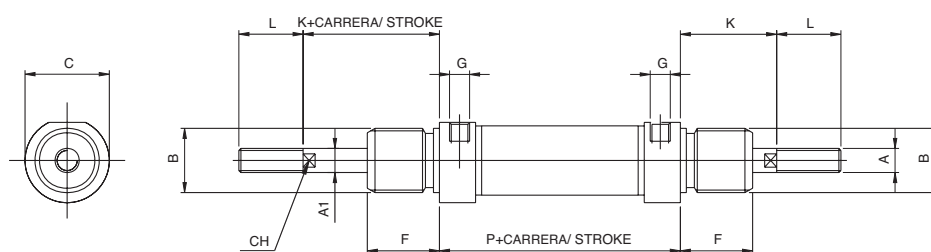

ϕ mm	A	A1	B	C	F	G	K	L	P	CH
16	M6	6	M16 x 1.5	21	18	M5	22	16	53	5
20	M8	8	M22 x 1.5	27	20	1/8G	24	20	67	7
25	M10 x 1.25	10	M22 x 1.5	30	22	1/8G	28	22	68	9