

Cilindri pneumatici

Pneumatic cylinders

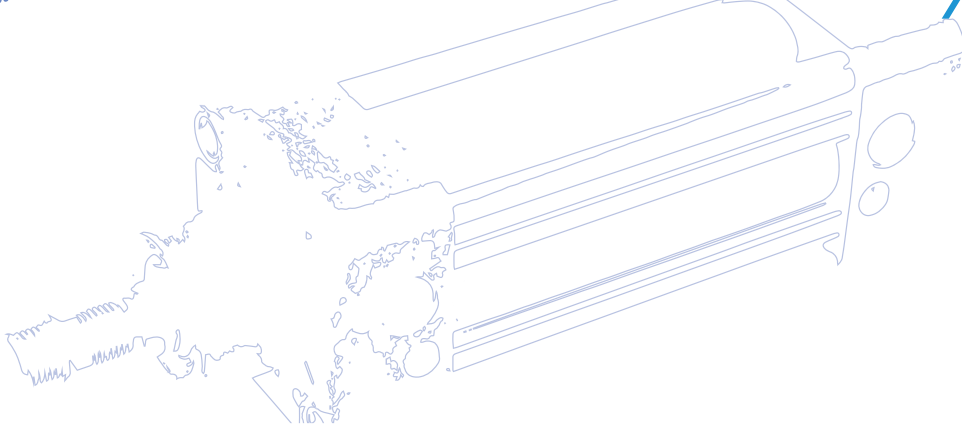

Indice / *Index*

Cilindri pneumatici / *Pneumatic cylinders*

- **Cilindri ISO 15552 ϕ 32- 250** / *ISO 15552 cylinders ϕ 32-250*
- **Minicilindri ISO 6432 ϕ 8-25** / *ISO 6432 minicylinders ϕ 8-25*
- **Cilindri tondi a profilo pulito ϕ 32-63** / *Round clean profile cylinders ϕ 32-63*
- **Cilindri compatti ISO 21287 ϕ 20-100** / *ISO 21287 compact cylinders ϕ 20-100*
- **Cilindri compatti a interfaccia ISO ϕ 125-250** / *Compact ISO interface cylinders ϕ 125-250*
- **Cilindri compatti UNITOP ϕ 12-100** / *Compact UNITOP cylinders ϕ 12-100*
- **Cilindri a corsa breve ϕ 12-100** / *Short stroke cylinders ϕ 12-100*
- **Cilindri antirotazione a steli gemellati ϕ 32-100** / *Antirotation cylinders with double rods ϕ 32-100*
- **Cilindri compatti guidati ϕ 16-50** / *Guided compact cylinders ϕ 16-50*
- **Cilindri rotanti a cremagliera ϕ 32-125** / *Rotary cylinders with rack ϕ 32-125*
- **Attuatori rotanti ϕ 15-25** / *Rotary actuators ϕ 15-25*
- **Cilindri a cartuccia ϕ 6-10-16** / *Cartridge cylinders ϕ 6-10-16*
- **Unità di guida lineare ϕ 32-100** / *Linear guide unit ϕ 32-100*
- **Accessori per cilindri** / *Accessories for cylinders*
- **Sensori per cilindri** / *Sensors for cylinders*

Cilindri ISO 15552 ϕ 32-250 / ISO 15552 cylinders ϕ 32-250



D A A

Diametro

Diameter

032-040

050-063

080-100

125-160

200-250

Corsa mm / Stroke mm

0025-0050-0075

0080-0100-0125

0150-0160-0200

0250-0300-0320

0350-0400-0450

0500-0600-0700

0800-0900-1000

0 = Doppio effetto stelo semplice

Double acting single rod

2 = Doppio effetto stelo passante

Double acting double rod

48 = Standard magnetico, guarnizioni dinamiche in poliuretano

Standard magnetic, polyurethane dynamic seals

39 = Standard non magnetico, guarnizioni dinamiche in poliuretano

Standard not magnetic, polyurethane dynamic seals

02 = Tutte le guarnizioni in viton / All viton seals

18 = Solo guarnizione tenuta stelo in viton / Only viton rod seal

01 = Stelo in acciaio inox / Stainless steel piston rod

16 = Semplice effetto molla anteriore (D. 32-100) / Single acting front spring (D. 32-100)

17 = Semplice effetto molla posteriore (D. 32-100) / Single acting rear spring (D.32-100)

Minicilindri ISO 6432 ϕ 8-25 / ISO 6432 Minicylinders ϕ 8-25



D B A

Diametro

Diameter

008-010

012-016

020-025

Corsa mm / Stroke mm

010-025-080

100-125-160

200-250-300

0 = Doppio effetto stelo semplice

Double acting single rod

2 = Doppio effetto stelo passante

Double acting double rod

00 = Standard magnetico, guarnizioni dinamiche in poliuretano

Standard magnetic, polyurethane dynamic seals

50 = Standard magnetico, con ammortizzatori regolabili (ϕ 16-20-25)

Standard magnetic, cushioned (ϕ 16-20-25)

02 = Tutte le guarnizioni in viton / All viton seals

18 = Solo guarnizione tenuta stelo in viton / Only viton rod seal

16 = Semplice effetto molla anteriore (corsa max 50 mm)

Single acting front spring (max stroke 50 mm)

17 = Semplice effetto molla posteriore (corsa 50 mm)

Single acting rear spring (max stroke 50 mm)

Cilindri tondi a profilo pulito ϕ 32-63 / Round clean profile cylinders ϕ 32-63



D D A

Diametro
Diameter
032-040
050-063

0 = Doppio effetto stelo semplice
Double acting single rod
2 = Doppio effetto stelo passante
Double acting double rod

Corsa mm / Stroke mm
010-025-050
080-100-125
160-200-250
320-400-500

00 = Standard magnetico, guarnizioni dinamiche in poliuretano
Standard magnetic, polyurethane dynamic seals
50 = Standard magnetico con ammortizzatori regolabili
Standard magnetic, cushioned
01 = Stelo in acciaio inox / Stainless steel rod
16 = Semplice effetto molla anteriore (corsa max 50 mm)
Single acting front spring (max stroke 50 mm)
17 = Semplice effetto molla posteriore (corsa 50 mm)
Single acting rear spring (max stroke 50 mm)

Cilindri compatti ISO 21287 ϕ 20-100 / ISO 21287 Compact cylinders ϕ 20-100



D M A

Diametro
Diameter
020-025
032-040
050-063
080-100

01 = Stelo maschio
Male rod
02 = Stelo femmina
Female rod

Corsa mm / Stroke mm
0005-0010-0015
0020-0025-0030
0040-0050-0060
0070-0080-0090
0100-0125-0150
0200

00 = Doppio effetto stelo semplice / Double acting single rod
20 = Doppio effetto stelo passante / Double acting double rod
01 = Stelo in acciaio inox / Stainless steel piston rod
16 = Semplice effetto molla anteriore (corsa max 25 mm)
Single acting front spring (max stroke 25 mm)
17 = Semplice effetto molla posteriore (corsa max 25 mm)
Single acting rear spring (max stroke 25 mm)
70 = Antirotazione / Antirotation

Cilindri compatti a interfaccia ISO ϕ 125-250 / Compact ISO interface cylinders ϕ 125-250



D	M	A				—			—			/				
Diametro Diameter						01 = Stelo maschio Male rod		Corsa mm / Stroke mm								
0125-0160						02 = Stelo femmina Female rod		0005-0010-0015								
0200-0250								0020-0025-0030								
								0040-0050-0060								
								0070-0080-0090								
								0100-0125-0150								
								0200-0320-0350								
								0400-0450-0500								
00 = Doppio effetto stelo semplice / Double acting single rod																
20 = Doppio effetto stelo passante / Double acting double rod																
01 = Stelo in acciaio inox / Stainless steel piston rod																

Cilindri compatti UNITOP ϕ 12-100 / Compact UNITOP cylinders ϕ 12-100



D	U	A				—			—			/				
Diametro Diameter						01 = Stelo maschio Male rod		Corsa mm / Stroke mm								
012-016						02 = Stelo femmina Female rod		0005-0010-0015								
020-025								0020-0025-0030								
032-040								0040-0050-0060								
050-063								0070-0080-0090								
080-100								0100								
00 = Doppio effetto stelo semplice / Double acting single rod																
20 = Doppio effetto stelo passante / Double acting double rod																
01 = Stelo in acciaio inox / Stainless steel piston rod																
16 = Semplice effetto molla anteriore (corsa max 25 mm) Single acting front spring (max stroke 25 mm)																
17 = Semplice effetto molla posteriore (corsa max 25 mm) Single acting rear spring (max stroke 25 mm)																
70 = Antirotazione / Antirotation																

Cilindri a corsa breve ϕ 12-100 / Short stroke cylinders ϕ 12-100



D	C	A				—			—			/				
Diametro Diameter						01 = Stelo maschio Male rod		Corsa mm / Stroke mm								
012-016						02 = Stelo femmina Female rod		0005-0010-0015								
020-025								0020-0025-0030								
032-040								0040-0050-0060								
050-063								0070-0080-0090								
080-100								0100								
00 = Doppio effetto stelo semplice / Double acting single rod																
20 = Doppio effetto stelo passante / Double acting double rod																
01 = Stelo in acciaio inox / Stainless steel piston rod																
16 = Semplice effetto molla anteriore (corsa max 25 mm) Single acting front spring (max stroke 25 mm)																
17 = Semplice effetto molla posteriore (corsa max 25 mm) Single acting rear spring (max stroke 25 mm)																
70 = Antirotazione / Antirotation																

Cilindri antirotazione a steli gemellati ϕ 32-100 / Antirotation cylinders with double rods ϕ 32-100



D F A [] [] []

Diametro

Diameter

032-040

050-063

080-100

[] [] [] / [] [] [] []

00 = Steli standard

Standard rods

01 = Steli in acciaio inox

Stainless steel rods

Corsa mm / Stroke mm

0025-0050-0080

0100-0125-0160

0200-0250-0300

0350-0400-0500

0600

0 = Doppio effetto stelo semplice / Double acting single rod

2 = Doppio effetto stelo passante ISO / Double acting double ISO rod

3 = Doppio effetto steli gemellati passanti / Double acting double twin rods

Cilindri compatti guidati ϕ 16-50 / Guided compact cylinders ϕ 16-50



D N A [] [] [] — [] [] — [] [] / [] [] [] []

Diametro

Diameter

016-020

025-032

040-050

00 = Standard

Corsa mm / Stroke mm

0010-0020-0025

0030-0040-0050

0075-0100-0125

0150-0175-0200

00 = Standard con bronzine / Standard with bushes

01 = Con cuscinetti a ricircolo di sfere / With ball-bearings

20 = Doppia flangia con bronzine / Double flange with bushes

21 = Doppia flangia con cuscinetti a ricircolo di sfere / Double flange with ball-bearings

Cilindri rotanti a cremagliera ϕ 32-125 / Rotary cylinders with rack ϕ 32-125



D R A [] [] [] — [] [] — [] [] / [] [] [] []

Diametro

Diameter

032-040

050-063

080-100

125

10 = Con regolazione

With regulation

Angolo di rotazione

Rotation angle

090°-180°-270°-360°

01 = Pignone maschio / Male pinion

00 = Pignone femmina / Female pinion

Attuatori rotanti ϕ 15-25 / Rotary actuators ϕ 15-25

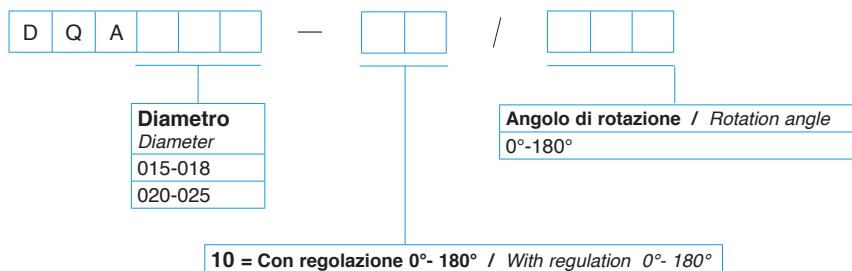

Cilindri a cartuccia ϕ 6-10-16 / Cartridge cylinders ϕ 6-10-16

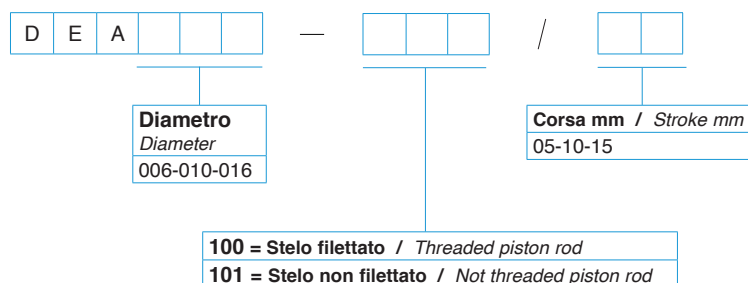
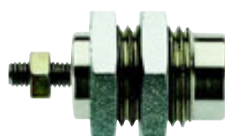

Unità di guida lineare ϕ 12-100 / Linear guide unit ϕ 12-100

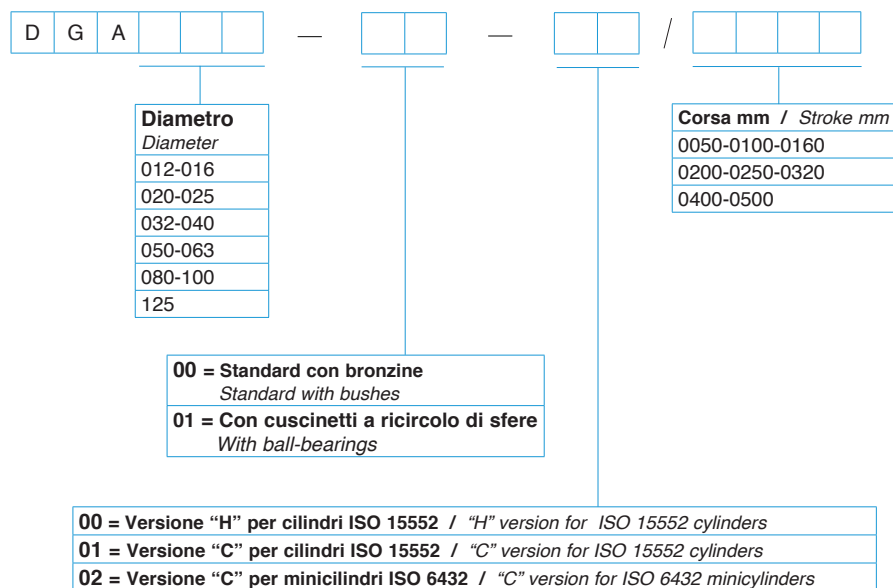

Bloccastelo / Clamping unit



	ϕ	
DHB032-00-00	32	
DHB040-00-00	40	
DHB050-00-00	50	
DHB063-00-00	63	
DHB080-00-00	80	
DHB100-00-00	100	
DHB125-00-00	125	

Flangia / Flange



	ϕ	
DAL032-01	32	
DAL040-01	40	
DAL050-01	50	
DAL063-01	63	
DAL080-01	80	
DAL100-01	100	
DAL125-01	125	
DAL160-01	160	
DAL200-01	200	
DAL250-01	250	

Piedino basso / Short foot



	ϕ	
DAL032-02	32	
DAL040-02	40	
DAL050-02	50	
DAL063-02	63	
DAL080-02	80	
DAL100-02	100	
DAL125-02	125	
DAL160-02	160	
DAL200-02	200	
DAL250-02	250	

Piedino basso largo / Short wide foot



	ϕ	
DAL032-03	32	
DAL040-03	40	
DAL050-03	50	
DAL063-03	63	
DAL080-03	80	
DAL100-03	100	

Cerniera femmina / Female hinge



	ϕ	
DAL032-04/A	32	
DAL040-04/A	40	
DAL050-04/A	50	
DAL063-04/A	63	
DAL080-04/A	80	
DAL100-04/A	100	
DAL125-04/A	125	
DAL160-04/A	160	
DAL200-04/A	200	
DAL250-04/A	250	

Cerniera maschio / Male hinge

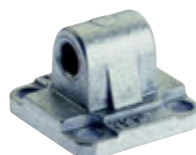

	ϕ	
DAL032-06/A	32	
DAL040-06/A	40	
DAL050-06/A	50	
DAL063-06/A	63	
DAL080-06/A	80	
DAL100-06/A	100	
DAL125-06/A	125	
DAL160-06/A	160	
DAL200-06/A	200	
DAL250-06/A	250	

Articolazione a squadra 90° / Square joint 90°



	ϕ	
DAL032-08/A	32	
DAL040-08/A	40	
DAL050-08/A	50	
DAL063-08/A	63	
DAL080-08/A	80	
DAL100-08/A	100	
DAL125-08/A	125	
DAL160-08/A	160	
DAL200-08/A	200	

Perno per cerniera con seeger

Pin for hinge with seeger



	ϕ	
DAL032-15	32	
DAL040-15	40	
DAL050-15	50	
DAL063-15	63	
DAL080-15	80	
DAL100-15	100	
DAL125-15	125	
DAL160-15	160-200	
DAL250-15	250	

Cerniera femmina stretta / Female narrow hinge



	ϕ	
DAL032-12/A	32	
DAL040-12/A	40	
DAL050-12/A	50	
DAL063-12/A	63	
DAL080-12/A	80	
DAL100-12/A	100	
DAL125-12/A	125	
DAL160-12/A	160	
DAL200-12/A	200	

Cerniera maschio con testina snodata DIN648K / Male hinge with DIN648K joint



	ϕ	
DAL032-13/A	32	
DAL040-13/A	40	
DAL050-13/A	50	
DAL063-13/A	63	
DAL080-13/A	80	
DAL100-13/A	100	
DAL125-13/A	125	
DAL160-13/A	160	
DAL200-13/A	200	

Articolazione a squadra 90° con testina snodata DIN648K / Square joint 90° with DIN648K joint

Square joint 90° with DIN648K joint



	ϕ	
DAL032-14	32	
DAL040-14	40	
DAL050-14	50	
DAL063-14	63	
DAL080-14	80	
DAL100-14	100	
DAL125-14	125	

Perno antirotazione / Anti-rotation pin



	ϕ	
DAL032-16	32	
DAL040-16	40	
DAL050-16	50	
DAL063-16	63	
DAL080-16	80	
DAL100-16	100	
DAL125-16	125	
DAL160-16	160-200	

Cerniera intermedia per cilindri a profilo pulito / Intermediate hinge for clean profile cylinders

Intermediate hinge for clean profile cylinders



	ϕ	
DAL032-10K	32	
DAL040-10K	40	
DAL050-10K	50	
DAL063-10K	63	
DAL080-10K	80	
DAL100-10K	100	
DAL125-10K	125	

Cerniera intermedia per cilindri a profilo tondo con tiranti / Intermediate hinge for round + tie rods cylinders

Intermediate hinge for round + tie rods cylinders



	ϕ	
DAL032-11	32	
DAL040-11	40	
DAL050-11	50	
DAL063-11	63	
DAL080-11	80	
DAL100-11	100	
DAL125-11	125	
DAL160-11	160	
DAL200-11	200	
DAL250-11	250	

Supporto per cerniera intermedia / Support for intermediate hinge

Support for intermediate hinge



	ϕ	
DAL032-17	32	
DAL040-17	40-50	
DAL063-17	63-80	
DAL100-17	100-125	
DAL160-17	160-200	
DAL250-17	250	

Forcella con clips / Fork joint with clips



	ϕ	
DAL032-18	32	
DAL040-18	40	
DAL050-18	50-63	
DAL080-18	80-100	
DAL125-18	125	
DAL160-18	160-200	
DAL250-18	250	

Snodo sferico / Ball joint



	ϕ	
DAL032-19	32	
DAL040-19	40	
DAL050-19	50-63	
DAL080-19	80-100	
DAL125-19	125	
DAL160-19	160-200	
DAL250-19	250	

Giunto auto-allineante / Self-alignment joint



	ϕ	
DBL020-20	20	
DAL032-20	32	
DAL040-20	40	
DAL050-20	50-63	
DAL080-20	80-100	

Dado per stelo / Nut for rod



	ϕ	
DAL032-21	32	
DAL040-21	40	
DAL050-21	50-63	
DAL080-21	80-100	
DAL125-21	125	
DAL160-21	160-200	
DAL250-21	250	

Accessori per minicilindri ISO 6432 / Accessories for ISO 6432 minicylinders

Bloccastelo / Clamping unit



	ϕ	
DHB020-00-00	20	
DHB025-00-00	25	

Flangia / Flange



	ϕ	
DBL008-01	8-10	
DBL012-01	12-16	
DBL020-01	20-25	

Piedino / Foot



	ϕ	
DBL008-02	8-10	
DBL012-02	12-16	
DBL020-02	20-25	

Cerniera oscillante / Clevis bracket



	ϕ	
DBL008-05	8-10	
DBL012-05	12-16	
DBL020-05	20-25	

Forcella con clips / Fork joint with clips



	ϕ	
DBL008-18	8-10	
DBL012-18	12-16	
DBL020-18	20	
DAL032-18	25	

Snodo sferico / Ball joint



	ϕ	
DBL008-19	8-10	
DBL012-19	12-16	
DBL020-19	20	
DAL032-19	25	

Dado per stelo / Nut for rod



	ϕ	
DBL008-21	8-10	
DBL012-21	12-16	
DBL020-21	20	
DAL032-21	25	

Ghiera per testata / Nut for head



	ϕ	
DBL008-22	8-10	
DBL012-22	12-16	
DBL020-22	20-25	

Accessori per cilindri tondi a profilo pulito / *Accessories for clean profile round cylinders*

Piedino / Foot



	ϕ	
DDL032-02	32	
DDL040-02	40	
DDL050-02	50	
DDL063-02	63	

Cerniera oscillante / Clevis bracket



	ϕ	
DDL032-05	32	
DDL040-05	40	
DDL050-05	50	
DDL063-05	63	

Dado per stelo / Nut for rod



	ϕ	
DAL032-21	32	
DAL040-21	40	
DAL050-21	50-63	

Ghiera per testata / Nut for head



	ϕ	
DDL032-22	32	
DDL040-22	40	
DDL050-22	50-63	

Fissaggio con 2 perni / Fixing with 2 pins



	ϕ	
DDL032-23	32	
DDL040-23	40	
DDL050-23	50	
DDL063-23	63	

Forcella con clips / Fork joint with clips



	ϕ	
DAL032-18	32	
DAL040-18	40	
DAL050-18	50-63	

Accessori per cilindri compatti UNITOP / *Accessories for compact UNITOP cylinders*

Flangia / Flange



	ϕ	
DUL012-01	12-16	
DUL020-01	20	
DUL025-01	25	
DUL032-01	32	
DUL040-01	40	
DUL050-01	50	
DUL063-01	63	
DUL080-01	80	
DUL100-01	100	

Piedino basso / Short foot



	ϕ	
DUL012-02	12-16	
DUL020-02	20	
DUL025-02	25	
DUL032-02	32	
DUL040-02	40	
DUL050-02	50	
DUL063-02	63	
DUL080-02	80	
DUL100-02	100	

Cerniera femmina / Female hinge



	ϕ	
DAL032-04/A	32	
DAL040-04/A	40	
DAL050-04/A	50	
DAL063-04/A	63	
DAL080-04/A	80	
DAL100-04/A	100	

Cerniera maschio / Male hinge



	ϕ	
DUL012-06/A	12-16	
DUL020-06/A	20	
DUL025-06/A	25	

Articolazione a squadra 90° / Square joint 90°



	ϕ	
DAL032-08/A	32	
DAL040-08/A	40	
DAL050-08/A	50	
DAL063-08/A	63	
DAL080-08/A	80	
DAL100-08/A	100	

Perno per cerniera con seeger

Pin for hinge with seeger



	ϕ	
DAL032-15	32	
DAL040-15	40	
DAL050-15	50	
DAL063-15	63	
DAL080-15	80	
DAL100-15	100	

Snodo sferico maschio / Male ball joint



	ϕ	
DUL020-19M	20-25	
DUL032-19M	32-40	
DUL050-19M	50-63	
DUL080-19M	80	
DUL100-19M	100	

NOTE SUI DISPOSITIVI DI FISSAGGIO

- Per i cilindri compatti ISO 21287 ϕ 20-25 utilizzare gli accessori dei cilindri compatti UNITOP
- Per i cilindri compatti ISO 21287 ϕ 32-100 utilizzare gli accessori dei cilindri ISO 15552
- Per i cilindri a corsa breve ϕ 20-25 utilizzare gli accessori dei cilindri compatti UNITOP
- Per i cilindri a corsa breve ϕ 32-100 utilizzare gli accessori dei cilindri ISO 15552
- Per i cilindri compatti a interfaccia ISO ϕ 125-250 utilizzare gli accessori dei cilindri ISO 15552

NOTES ABOUT ACCESSORIES

- For ISO 21287 compact cylinders ϕ 20-25 use the accessories of compact UNITOP cylinders
- For ISO 21287 compact cylinders ϕ 32-100 use the accessories of ISO 15552 cylinders
- For short stroke cylinders ϕ 20-25 use the accessories of compact UNITOP cylinders
- For short stroke cylinders ϕ 32-100 use the accessories of ISO 15552 cylinders
- For compact ISO interface cylinders ϕ 125-250 use the accessories of ISO 15552 cylinders

DSA02F-00-00



DSA02F-00-00



Sensore reed / *Reed sensor*
5-120 V. AC/DC
2 fili / 2 wires
Cavo / Cable: 2,5 mt

DSE13F-00-00



DSE13F-00-00



Sensore elettrico hall / *Electronic sensor hall:*
10-30 V. DC
3 fili / 3 wires
Cavo / Cable: 2 mt

Staffa per sensori su mincilindro ISO 6432

Bracket for sensors on minicylinder ISO 6432



D B L — 9 0

Diametro cilindro
Cylinder diameter
 008-010-012
 016-020-025